

# QuickStart Guide

## Configure your SHUTR® system – with a Controller (Part 1)

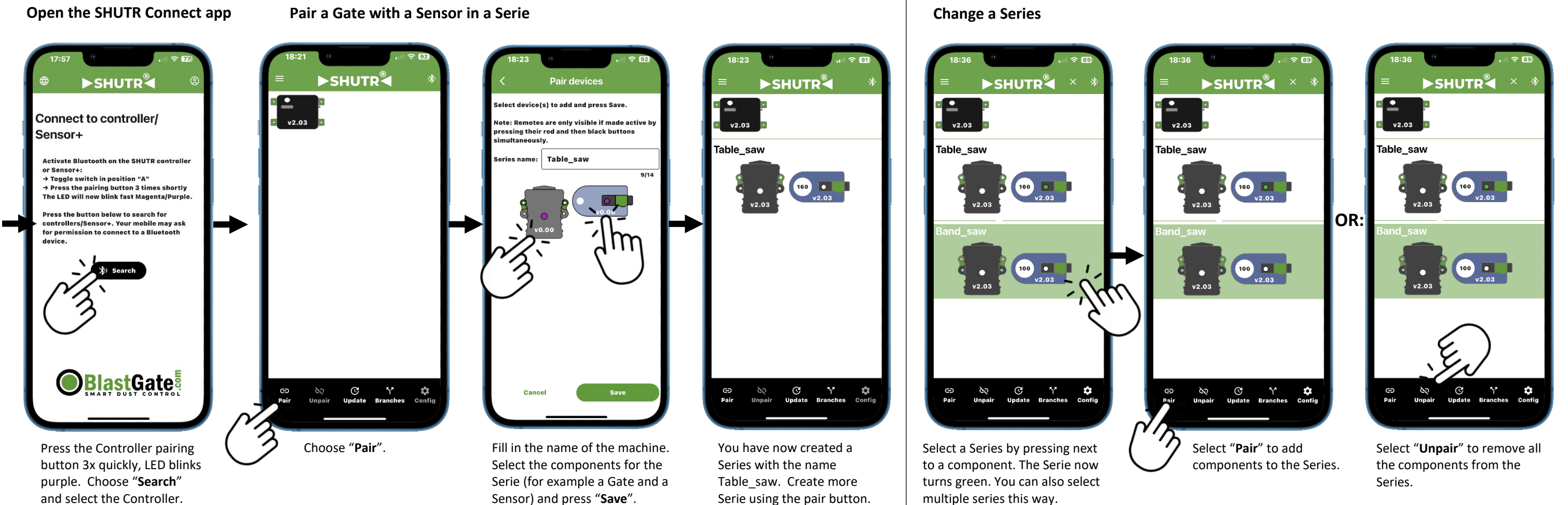

Pair a Remote

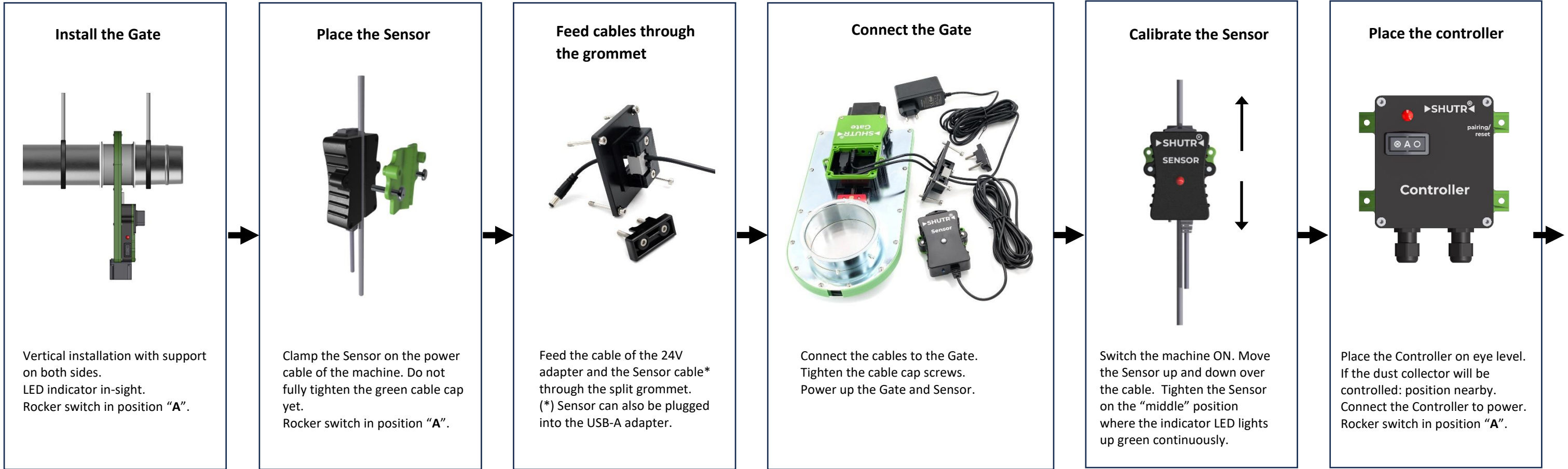
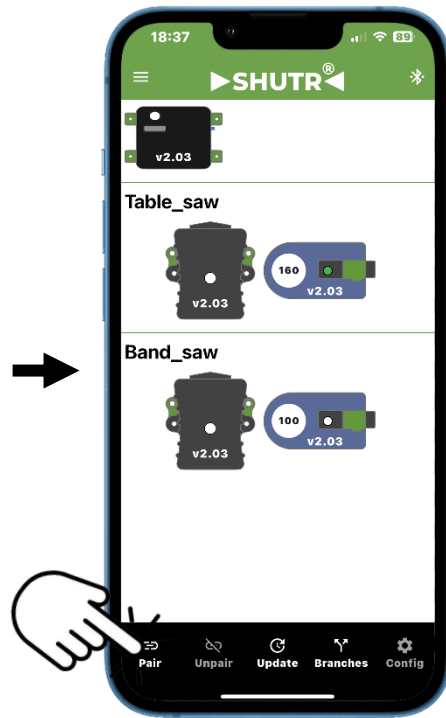
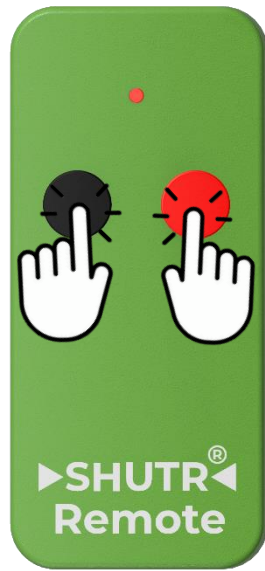

Press "Pair".

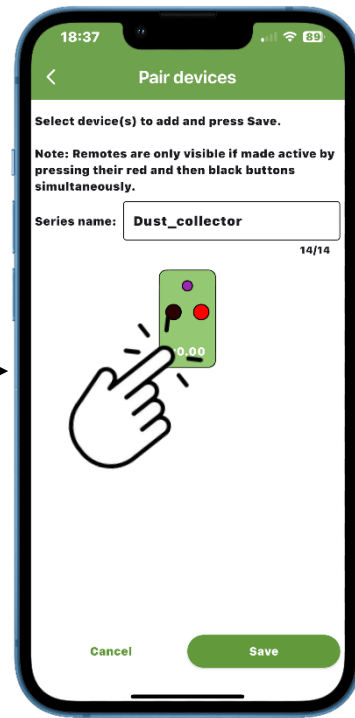

Select the Remote and press "Save".

Press both buttons and release them again. The Remote will be active for 1 minute.

Switch the dust collector with a Remote only

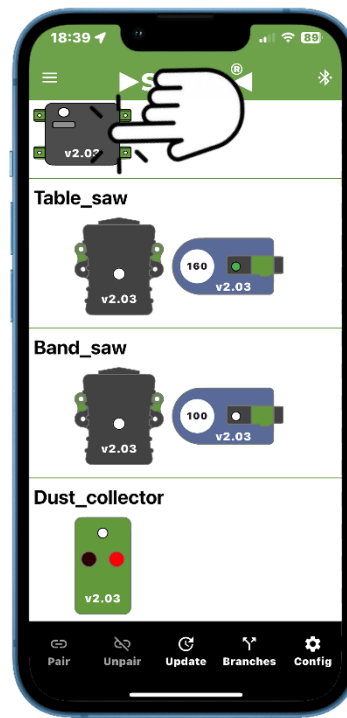

Select the Controller and then press "Config".

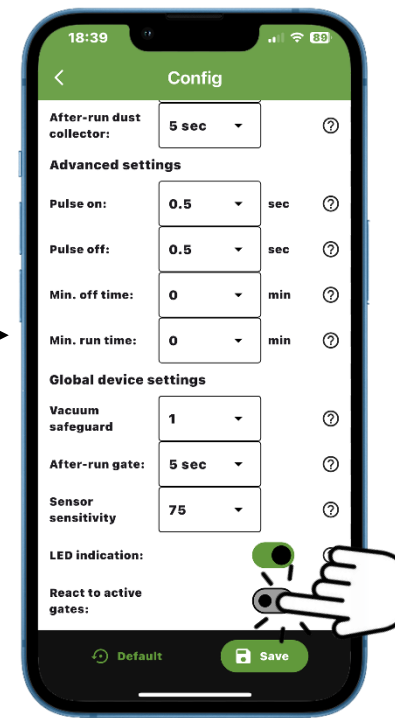

Scroll down and turn off "React to Gates". Then press "Save".

Adjust Sensor sensitivity

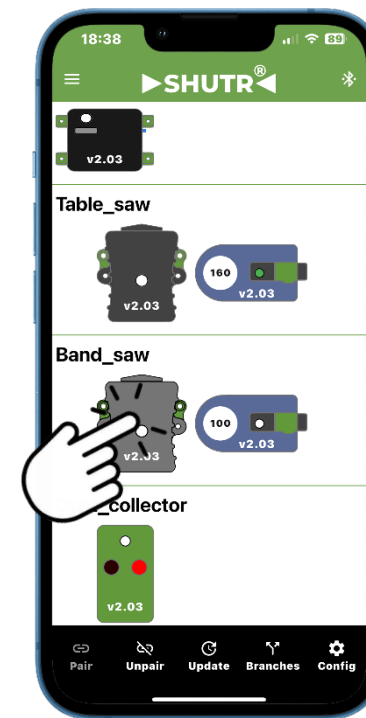

Select a Sensor and press "Config".

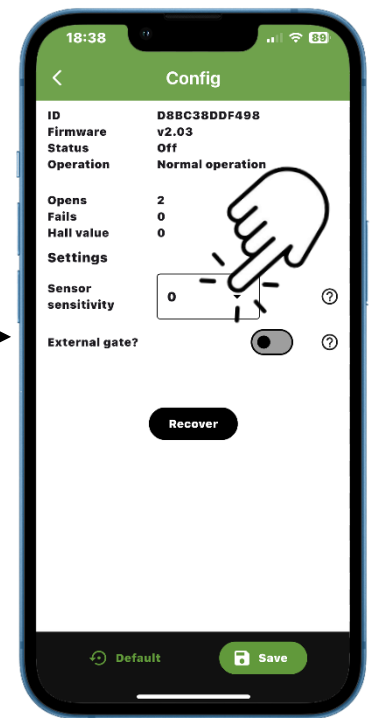

Choose a new number. Higher is less sensitive. The Hall value is the measured value on that moment.

Set the minimum number of open Gates

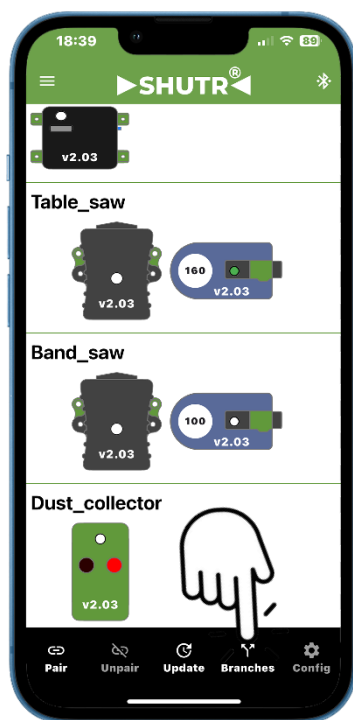

Select "Branches".

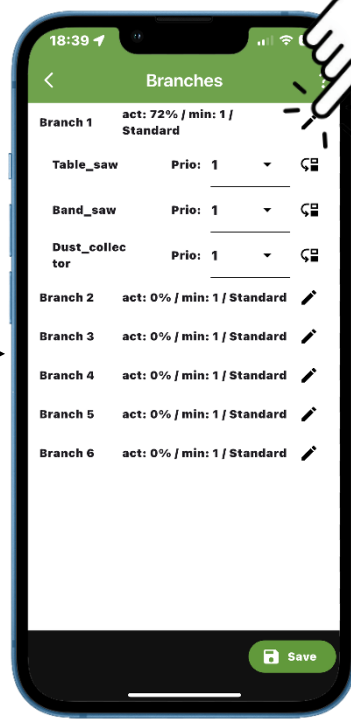

Press on the little pencil. Set the desired no of open Gates and press "Save".

Vacuum safeguard & Global after-run Gate

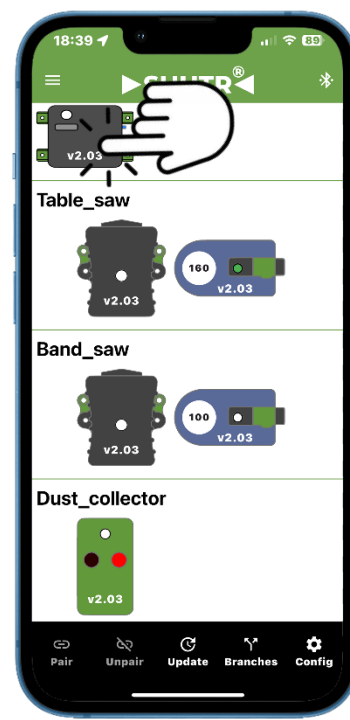

Select the Controller and press "Config".

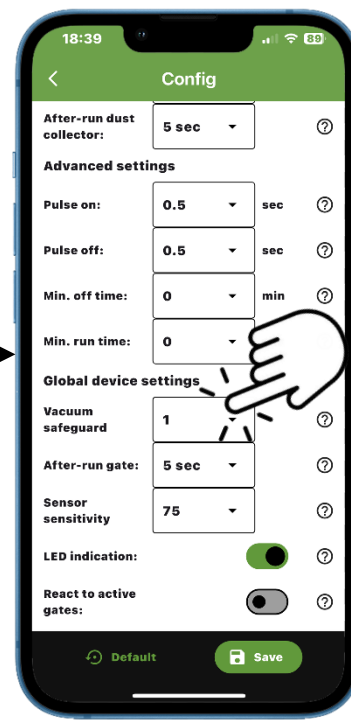

Select "Vacuum safeguard" and select the desired minimum number of open Gates before the dust collector will start up.

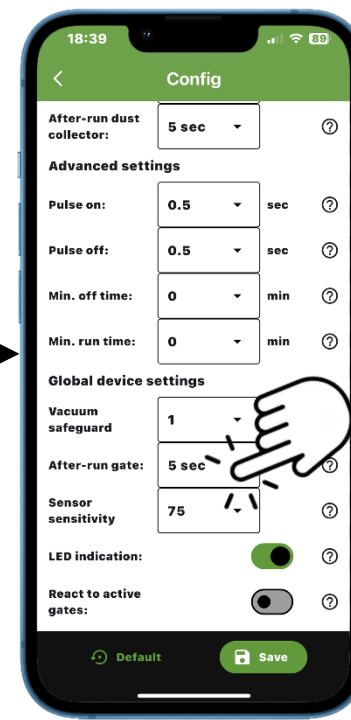

Select "After-run gate" and set the desired number of seconds. Then press "Save".

Set the after-run of an individual Gate

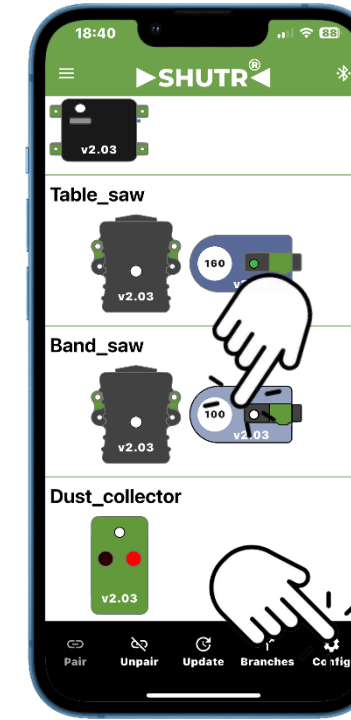

Select a Gate and then press "Config".

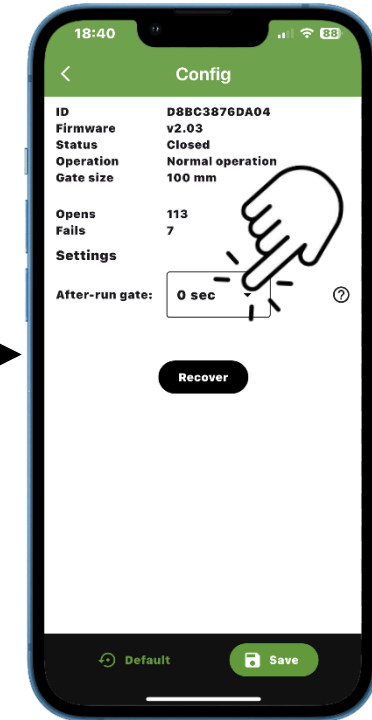

Set the after-run and press "Save". Overrides the global "After-run gate".